

# Leasowe Road, Brereton, Rugeley, WS15 1EY

£170,000

3 1 1



**\*\* ONLINE VIRTUAL TOUR AVAILABLE ON THIS PROPERTY - why not take a peek before booking a viewing\*\***

## Key Features

- NO UPWARD CHAIN
- LOUNGE
- THREE BEDROOMS
- GOOD SIZE REAR GARDEN
- POPULAR RESIDENTIAL LOCATION
- KITCHEN
- FAMILY BATHROOM
- VIEWING ADVISED

Approx Gross Internal Area  
77 sq m / 830 sq ft

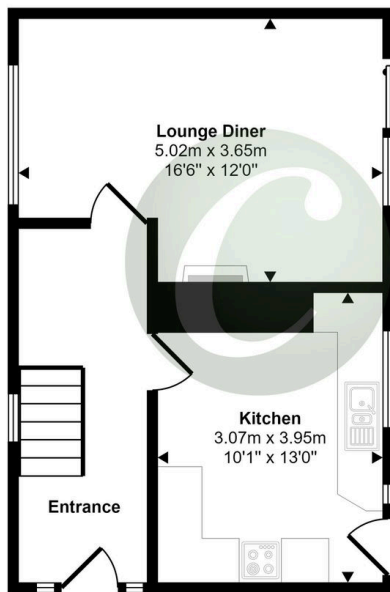

Ground Floor  
Approx 39 sq m / 415 sq ft

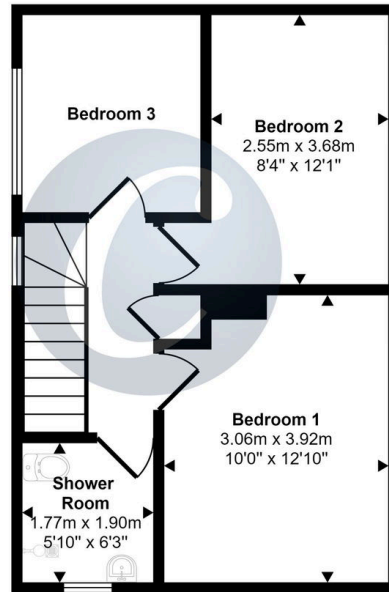

First Floor  
Approx 39 sq m / 415 sq ft

This floorplan is only for illustrative purposes and is not to scale. Measurements of rooms, doors, windows, and any items are approximate and no responsibility is taken for any error, omission or mis-statement. Icons of items such as bathroom suites are representations only and may not look like the real items. Made with Made Snappy 360.